

Current Switches: Adjustable Trip Point, Standard Output

Detect Belt Loss, Coupling Shear, And Mechanical Failure

APPLICATIONS

- Detecting belt loss, coupling shear, and mechanical failure
- Verifying lighting circuit and other electrical service run times
- Monitoring status of industrial process equipment
- Monitoring status of critical motors (compressor, fuel, etc.)

FEATURES

High performance devices in split- and solid-core housings

- Minimum trip point as low as 0.5A (H608)...eliminates the need for multiple wraps of the conductor through the sensor even on loads as small as 1/5HP
- Small size...fits easily inside small enclosures
- Self-gripping iris on the split-core housing for easy installation
- Status LEDs for easy setup and local indication (no LED on the H701)
- Bracket on H908 can be installed in three different configurations
- 1 Amp status output for increased application flexibility
- All devices are 100% solid state and polarity insensitive, with a 5-year warranty



DESCRIPTION

Hx08 Series and H701 current switches offer high performance, with a wide array of amperage range options. These products can accurately detect belt loss, coupling shear, or other mechanical failure on loads from 1/5 to 100HP.



Detects belt loss/coupling shear!

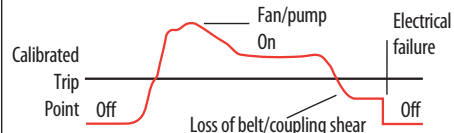

Now you can easily detect when drive belts slip, break, or pump couplings shear. In fact, a typical HVAC motor that loses its load has a reduction of current draw of up to 50%. That's why our sensors are the industry standard for status.

SPECIFICATIONS

Sensor Power	Induced from monitored conductor
Insulation Class	600VAC RMS (UL), 300VAC RMS (CE)
Frequency Range	50/60 Hz
Temperature Range	-15° to 60°C (5° to 140°F)
Humidity Range	10-90% RH, non-condensing
Hysteresis	10% (typical)
Terminal Block Maximum Wire Size	14 AWG (16 AWG for H308)
Terminal Block Torque (nominal)	4 in.-lbs (7 in.-lbs for H308)

UL 508 open device listing; CE: EN61010-1:2001-02, CAT III, deg. 2, basic insulation
Do not use the LED status indicators as evidence of applied voltage.

DIMENSIONAL DRAWINGS

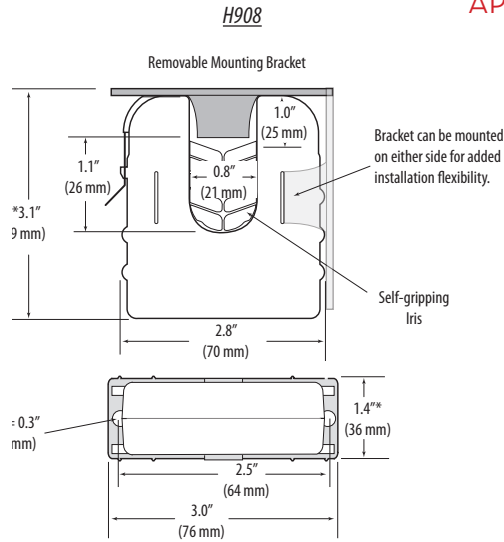
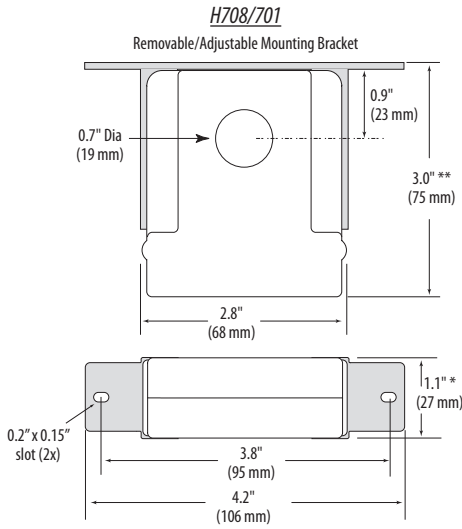
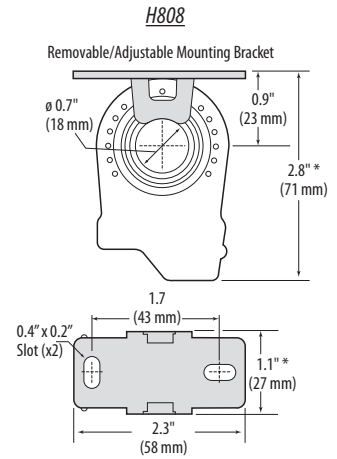
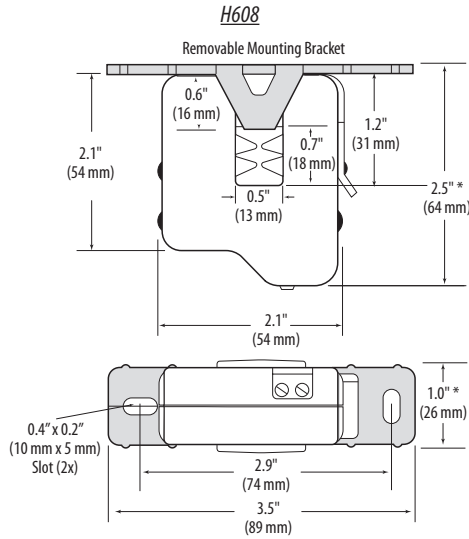
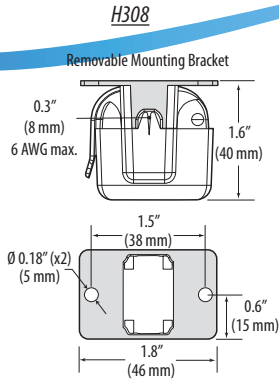

APPLICATION/WIRING DIAGRAM

Monitoring Fan /Pump Motors for Positive Proof of Flow

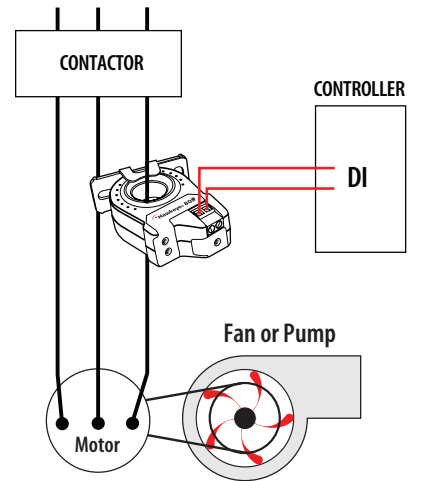

* Terminal block may extend up to 1/8" over the height dimensions shown.

ORDERING INFORMATION



MODEL	AMPERAGE RANGE	STATUS OUTPUT (max.)	MIN. TRIP POINT	HOUSING	STATUS LED	UL	CE	RoHS
H308	0.75 - 50A	N.O. 1.0A@30VAC/DC	0.75A or less	Split-Core	●	●	● ²	●
H608	0.5 - 175A		0.5A or less	Split-Core	●	● ¹	●	●
H701	1 - 135A		1.0A or less	Solid-Core	●	●	●	●
H708	1 - 135A		1.0A or less	Solid-Core	●	●	●	●
H808	0.75 - 50A		0.75A or less	Solid-Core	●	●	●	●
H908	2.5 - 135A		2.5A or less	Split-Core	●	●	●	●

For high voltage outputs, see page 26.

¹ Listed for use on 75°C insulated conductors.

² Product provides functional insulation only.

ACCESSORIES

DIN Rail Clip Set (AH01, AH27)
DIN Rail (AV01) and DIN Stop Clip (AV02)